



1408/22 Cambridge Street Epping NSW

3 2 2

Presenting an exquisite and opulent three-bedroom apartment nestled within the prestigious POLY HORIZON building in the coveted locale of Epping. This sophisticated residence exudes luxury and comfort, enveloped by meticulously landscaped gardens that create an oasis of tranquillity. Perched gracefully on the 14th floor, this divine abode boasts a north orientation, granting breathtaking panoramic views of the majestic park.

Property Features:

? Impeccably designed with a seamless blend of spaciousness and elegance, setting a new standard for modern living.

? Three expansive bedrooms adorned with built-in

Type : Unit

Price : \$ 1,278,000

View : <https://www.bmerealestate.com.au/sale/nsw/north-hern-suburbs/epping/residential/unit/7699245>



Jeff (kwok Fu) Chau
02 9739 9266

[For full version visit the website](https://www.bmerealestate.com.au)

STORAGE
1.3 x 1.8m

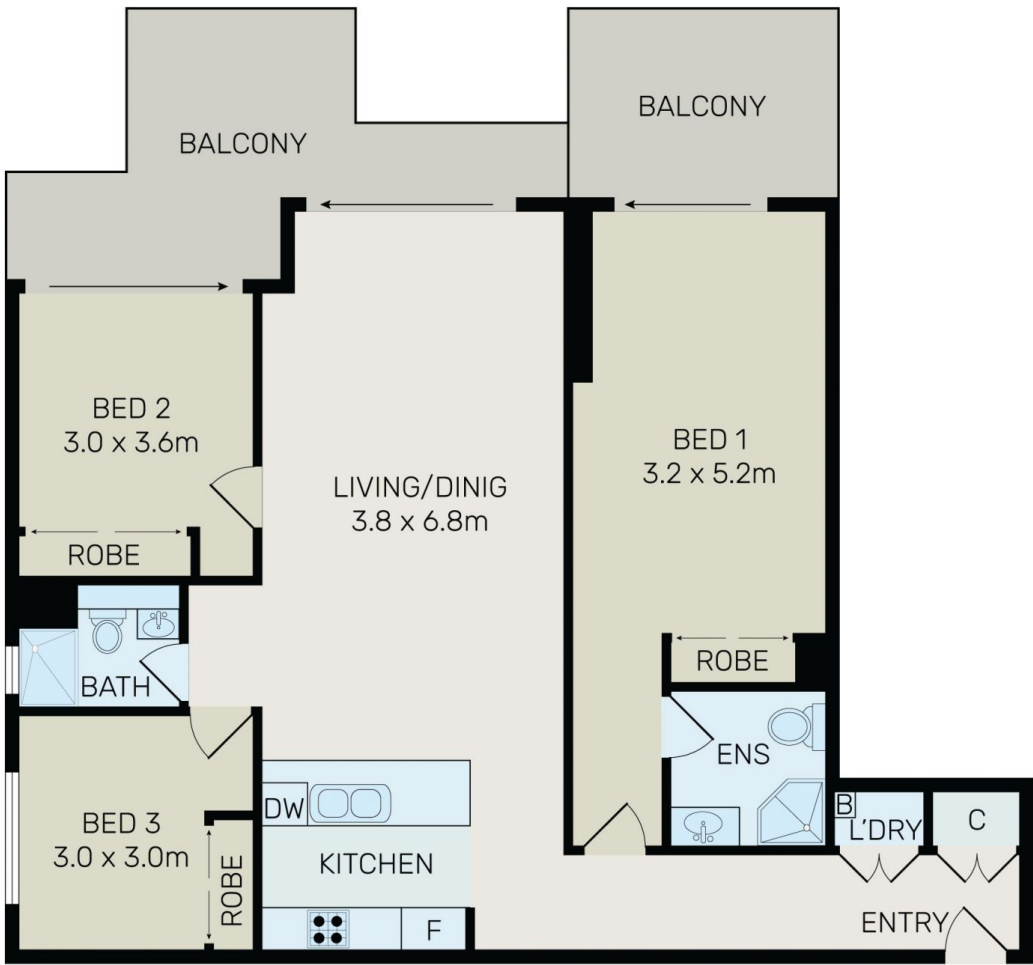

All information contained herein is gathered from all sources we believe to be reliable. However we cannot guarantee its accuracy and interested parties should rely on their own enquiries.



A1408/22 Cambridge Street, Epping