



507/40 McEvoy Street Waterloo NSW

2 2 1

This impeccably designed apartment sets a new standard in luxury living. Nestled within the secure 'Tribeca' building, it offers a blend of opulence and precision in its construction and design. Positioned to capture the northern sun, this apartment is a sanctuary of comfort and style. Residents of 'Tribeca' are treated to a wealth of resort-style amenities and beautifully landscaped communal areas, enhancing their overall living experience.

Conveniently situated a mere 4 kilometres from Sydney's bustling CBD, this 2-bedroom apartment offers more than just a stunning interior. It is within walking distance of Green Square Train Station, the vibrant East Village shopping center, the state-of-the-art Gunyama Park Aquatic & Recreation Centre, the creative hub of Danks

Type : Unit
View : <https://www.bmerealestate.com.au/sale/nsw/eastern-suburbs/waterloo/residential/unit/7752609>



John (junjie) Zhu
02 9739 9266

[For full version visit the website](https://www.bmerealestate.com.au)

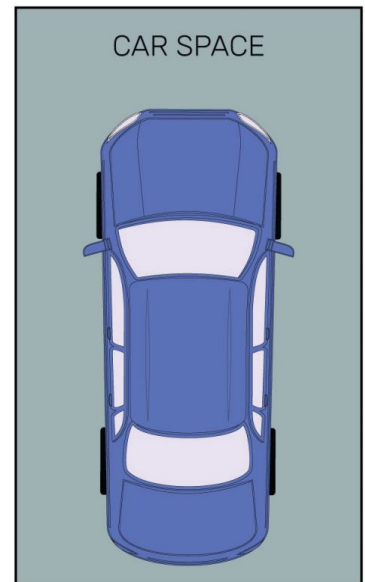
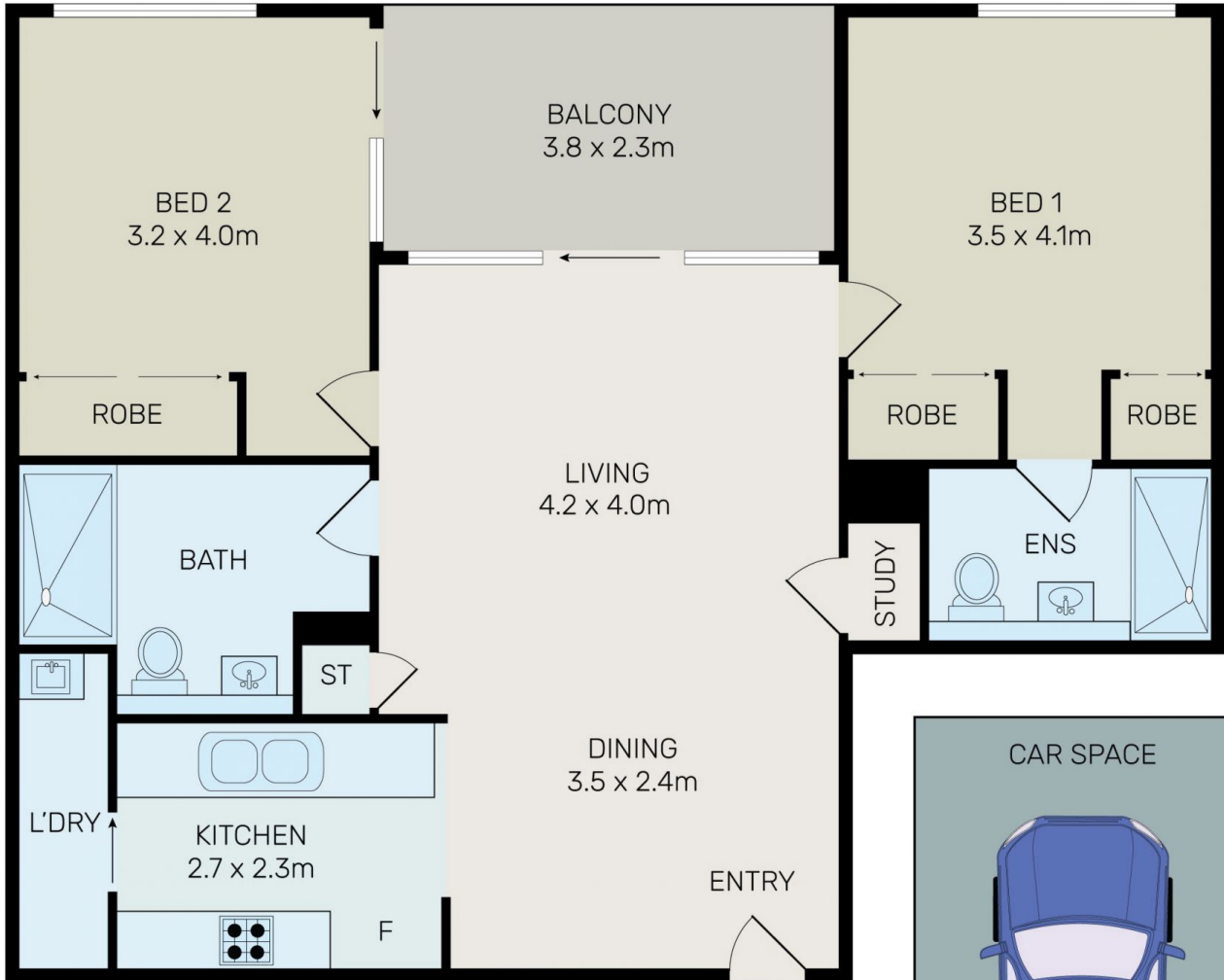

All information contained herein is gathered from all sources we believe to be reliable. However we cannot guarantee its accuracy and interested parties should rely on their own enquiries.



507/40 Mcevoy Street, Waterloo