



615/13 Verona Drive Wentworth Point NSW

1 1 1

This cozy one-bedroom apartment is superbly positioned just 18 kilometres from the heart of Sydney's CBD within the renowned "Savannah" complex, a prestigious development by Sekisui House, a highly respected Japanese community developer. Offering a truly luxurious lifestyle, the complex provides residents with access to a range of exceptional resort-style amenities, including a well-equipped gym, an indoor swimming pool, BBQ facilities, and the convenience of an on-site Building Manager, exclusively available to "Savannah" residents.

Nestled amidst serene parklands and along the picturesque shores of Homebush Bay, this modern luxury apartment promises a tranquil and contemporary living experience for potential buyers. It's perfectly situated within walking

[For full version visit the website](#)

**Type** : Unit  
**Building Size** : 82 sqm  
**View** : <https://www.bmerealestate.com.au/sale/nsw/inner-west/wentworth-point/residential/unit/7802338>



**John (junjie) Zhu**  
02 9739 9266



**Jeff (kwok Fu) Chau**  
02 9739 9266

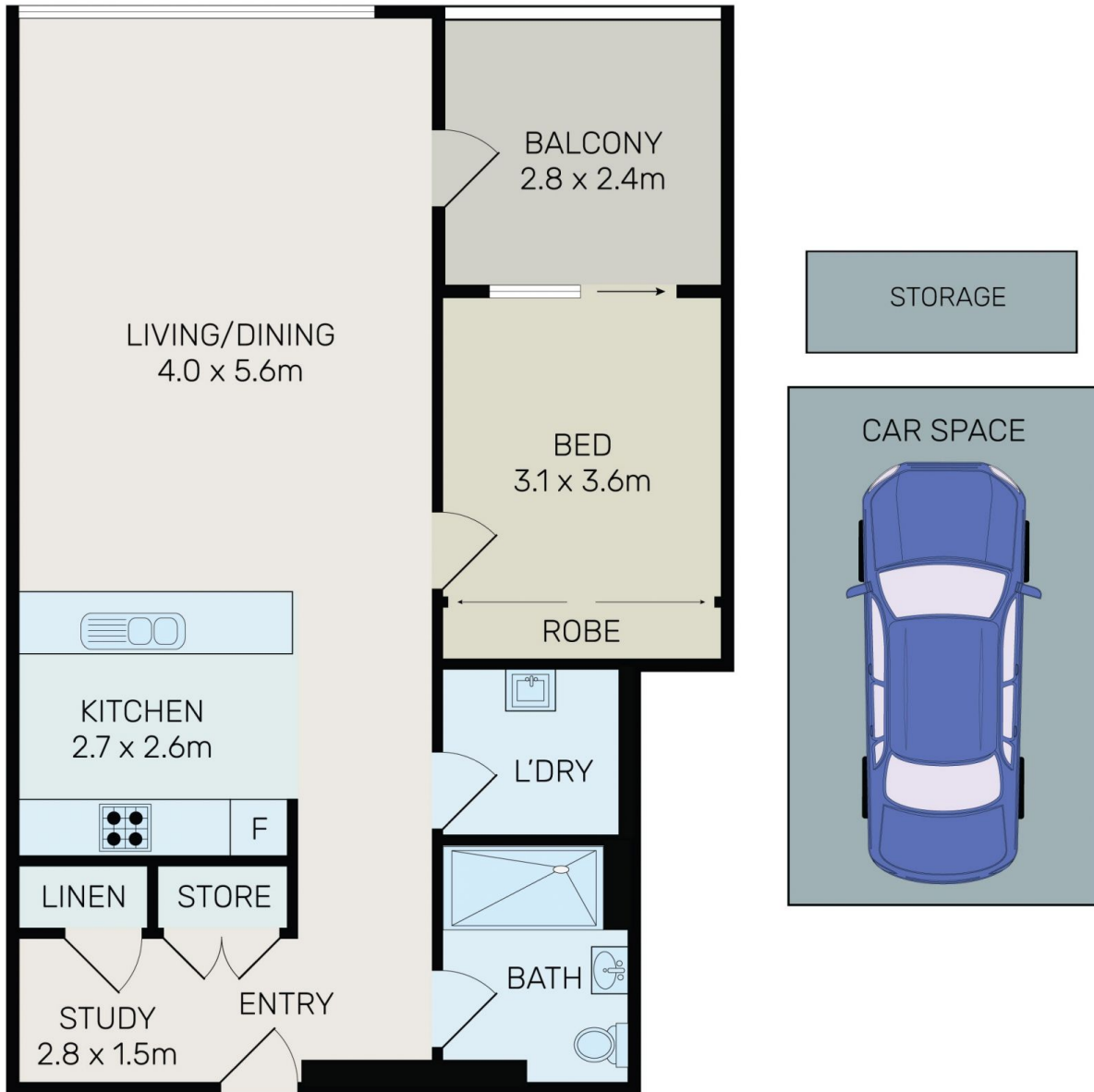

All information contained herein is gathered from all sources we believe to be reliable. However we cannot guarantee its accuracy and interested parties should rely on their own enquiries.



**615/13 Verona Drive, Wentworth Point**