



701/19 Verona Drive Wentworth Point NSW

2 2 1

If you're seeking the epitome of waterfront living coupled with unbeatable convenience, look no further than this fabulous 2-bedroom apartment. Situated within walking distance to Marina Square Shopping Centre, Wentworth Point Public School, local shops, cafes, restaurants, bus stops, Olympic Park ferry wharf, and Bennelong Bridge, this residence offers unparalleled access to all your daily essentials.

Designed with both modern sophistication and warm comfort in mind, this beautiful North aspect with tranquil communal garden view apartment provides the perfect blend of style and coziness. Whether you're relaxing indoors or taking in the views from your balcony, you'll feel right at home in this meticulously crafted space.

[For full version visit the website](#)

Type : Apartment
Price : \$ 850,000
Building Size : 111 sqm
View : <https://www.bmerealestate.com.au/sale/nsw/inner-west/wentworth-point/residential/apartment/7976023>



John (junjie) Zhu
02 9739 9266

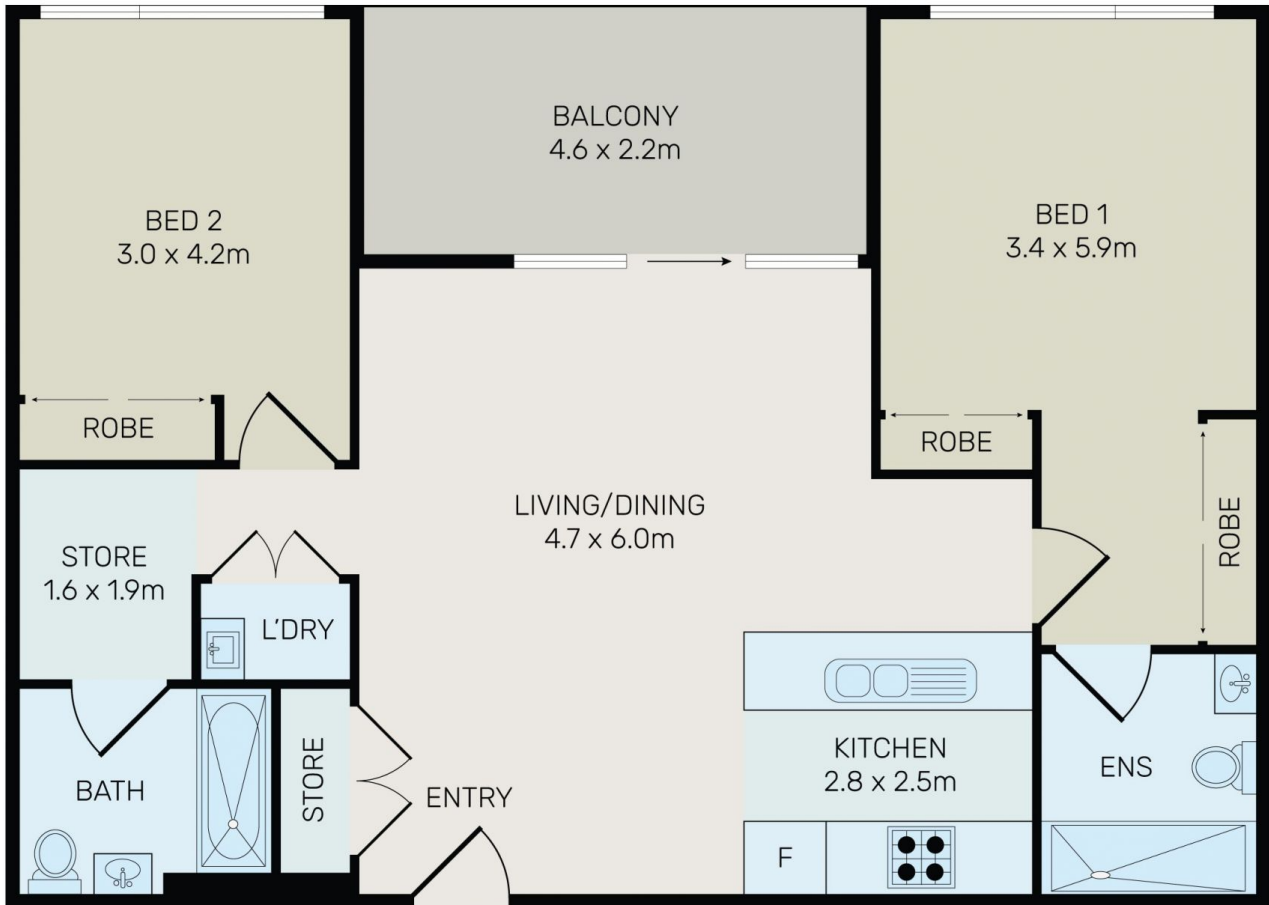
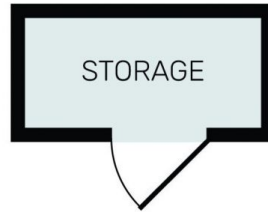
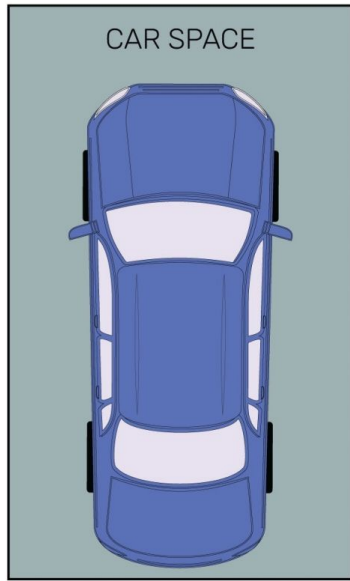

All information contained herein is gathered from all sources we believe to be reliable. However we cannot guarantee its accuracy and interested parties should rely on their own enquiries.

701/19 Verona Drive, Wentworth Point