

Actual View



1801/1 Australia Avenue Sydney Olympic Park NSW

2 2 1

This apartment sounds absolutely stunning with its 18th-floor position offering north aspect and breathtaking views of both water and parkland view. Here's a condensed version of the listing:

Luxurious Olympic Park Apartment with Spectacular Views
Location: Centrally located within an architecturally designed complex.

Features:

- ? Open plan living and dining area with timber look flooring and ample natural light.
- ? Modern kitchen with natural gas cooking, stone benchtops, and quality appliances.
- ? Extra study area to be able to work from home
- ? Two spacious bedrooms with built-in robes including ensuite for master bed

[For full version visit the website](#)

Type : Apartment

Price : \$ 710,000

View : <https://www.bmerealestate.com.au/sale/nsw/inne-r-west/sydney-olympic-park/residential/apartment/8039627>



Jeff (kwok Fu) Chau
02 9739 9266

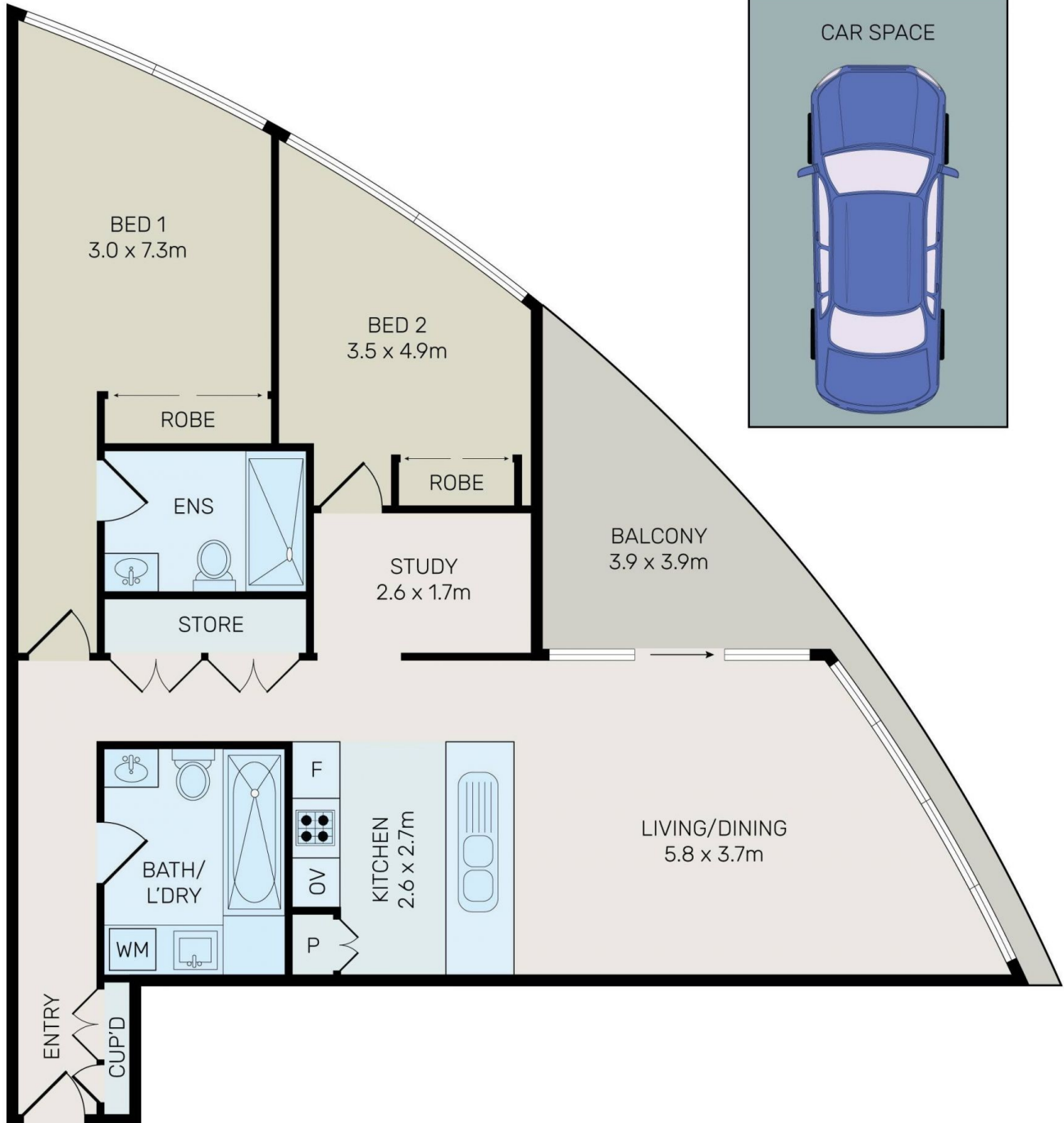
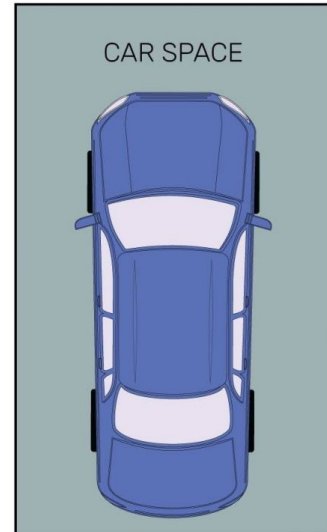
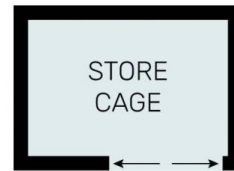

All information contained herein is gathered from all sources we believe to be reliable. However we cannot guarantee its accuracy and interested parties should rely on their own enquiries.



1801/1 Australia Avenue, Sydney Olympic Park