



107W/138 Carillon Avenue Newtown NSW

1 1

Ideally positioned in the highly sought-after inner-west, this contemporary apartment offers an exceptional blend of space, comfort, and convenience. The open-plan design effortlessly extends to a generous alfresco area, perfect for both entertaining and relaxation, while premium finishes throughout exude a sense of sophistication.

Situated just a short stroll from RPA Hospital, Camperdown Memorial Rest Park, and a vibrant selection of global eateries, this residence is also mere moments from Newtown Station, Sydney University, and Broadway Shopping Centre. A premier lifestyle opportunity with every convenience at your doorstep.

Apartment Features:

[For full version visit the website](https://www.bmerealestate.com.au)

Type	: Apartment
Price	: \$685,000
Building Size	: 57 sqm
View	: https://www.bmerealestate.com.au/sale/nsw/inner-west/newtown/residential/apartment/8126863



John (junjie) Zhu
02 9739 9266

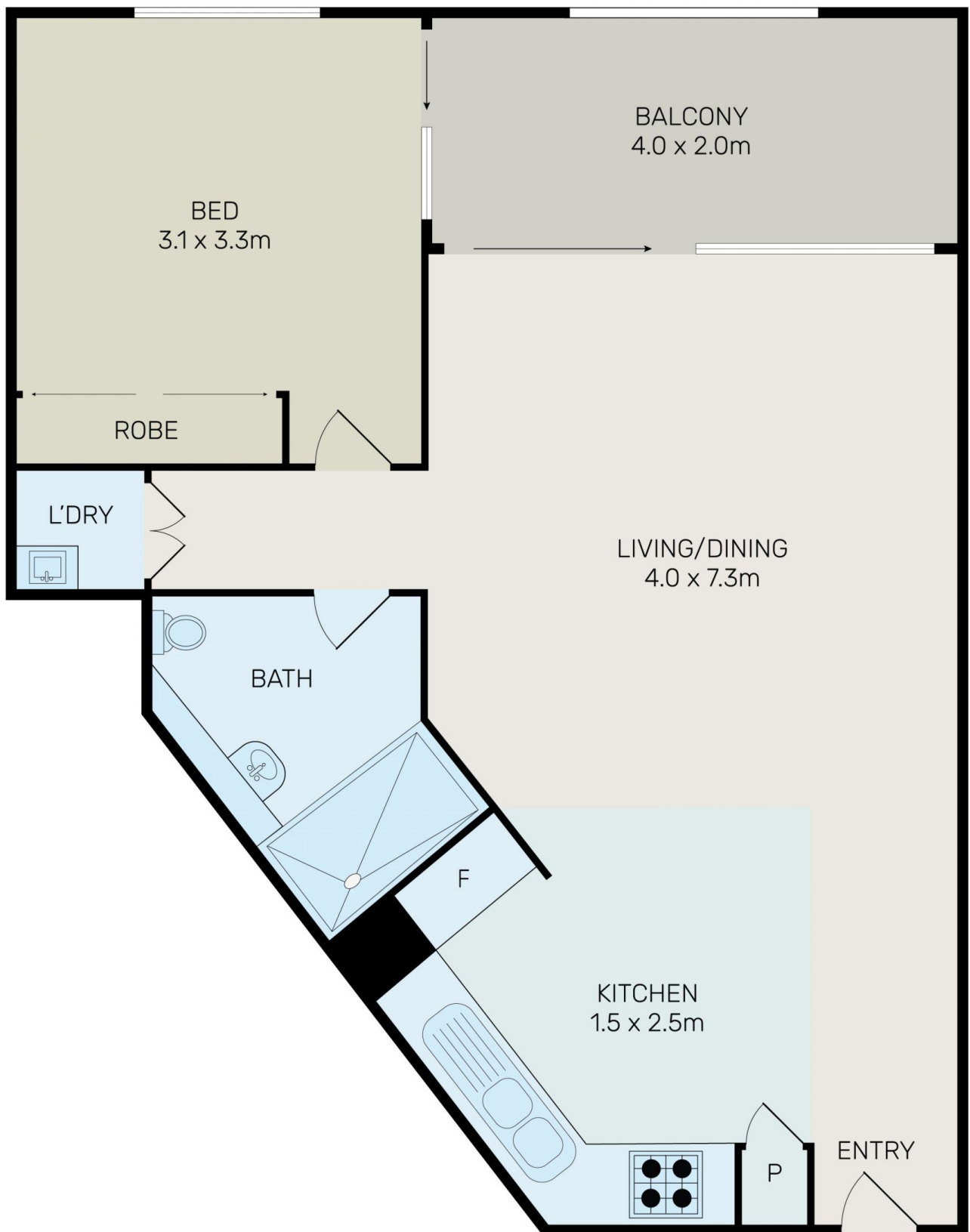

All information contained herein is gathered from all sources we believe to be reliable. However we cannot guarantee its accuracy and interested parties should rely on their own enquiries.



107W/138 Carillon Avenue, Newtown