

## 1502/13 Verona Drive Wentworth Point NSW

1 1 1

Set amid lush parklands and the serene waters of Homebush Bay, this contemporary one-bedroom luxury apartment is located in the prestigious "Savannah" complex. Residents enjoy a wealth of resort-style amenities, including a state-of-the-art gym, a refreshing indoor swimming pool, BBQ facilities, and the convenience of an onsite building manager.

Positioned on the 15th floor, this stunning apartment provides sweeping views of the Parramatta River, stretching all the way to the Sydney CBD. The open-concept layout ensures that these spectacular vistas can be appreciated from every area of the home. Whether you're enjoying a leisurely breakfast in the dining space, relaxing in the inviting lounge, stepping out onto the

**Type** : Apartment  
**Price** : Under Offer!!! More Properties Wanted!!!  
**Building Size** : 80 sqm  
**View** : <https://www.bmerealestate.com.au/sale/nsw/inner-west/wentworth-point/residential/apartment/8131224>

[For full version visit the website](https://www.bmerealestate.com.au)



**John (junjie) Zhu**  
02 9739 9266



**Elaine Chu**  
02 9739 9266

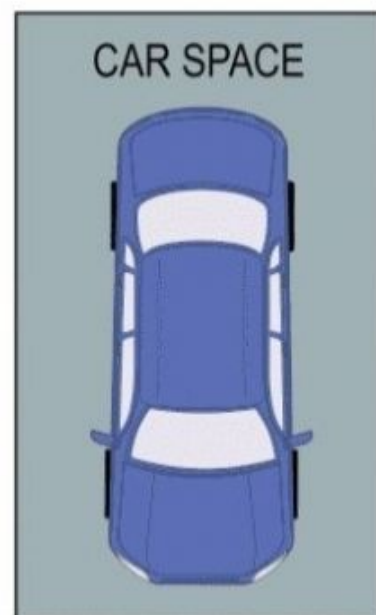
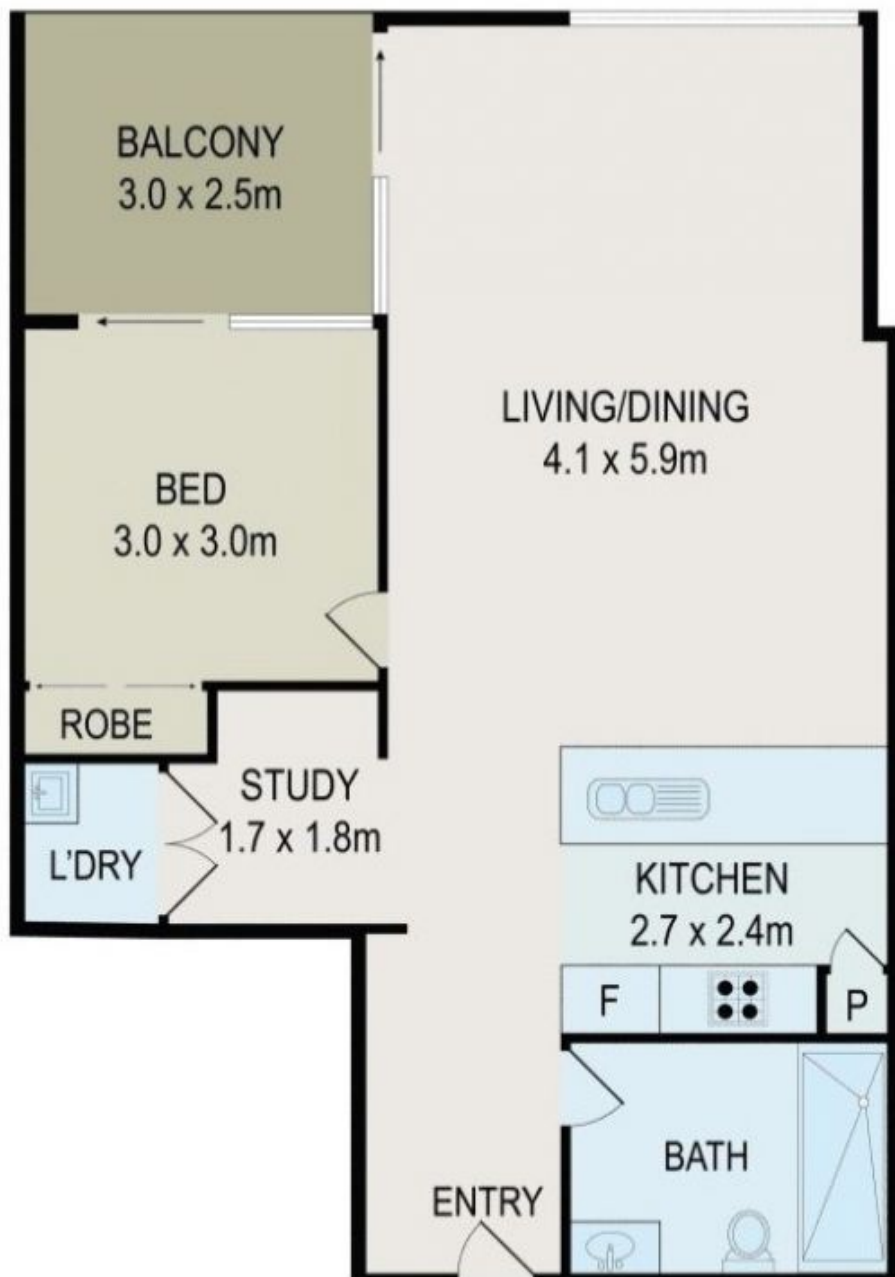

**1502/13 Verona Drive, Wentworth Point, NSW, 2127**